



PATENT NUMBER: 15/681,274



## OWNERS MANUAL

ASSEMBLY INSTRUCTIONS,  
MAINTENANCE AND WARRANTY



## Unpacking your FlexDrive-3D.

### Your package should contain:

- (A) (1) Upper Drive Unit
- (B) (2) Pedal Cranks
- (C) (2) Crank Arm Bolts
- (D) (2) T-bolts and Thumb Screws
- (E) (1) 3/32" Allen Wrench for Output Drive Coupling
- (F) (1) 1/8" Allen Wrench for Grease Screws
- (G) (1) 3mm Allen Wrench for Prop Screw
- (H) (1) 8 mm Allen Wrench
- (I) (1) Single Use Loctite (For Crankarm Bolts)
- (J) (1) Grease Gun
- (K) (1) Finish Line Grease

### Replacement Parts

- (L) (1) Spider Coupling
- (M) (1) Prop Shear Pin

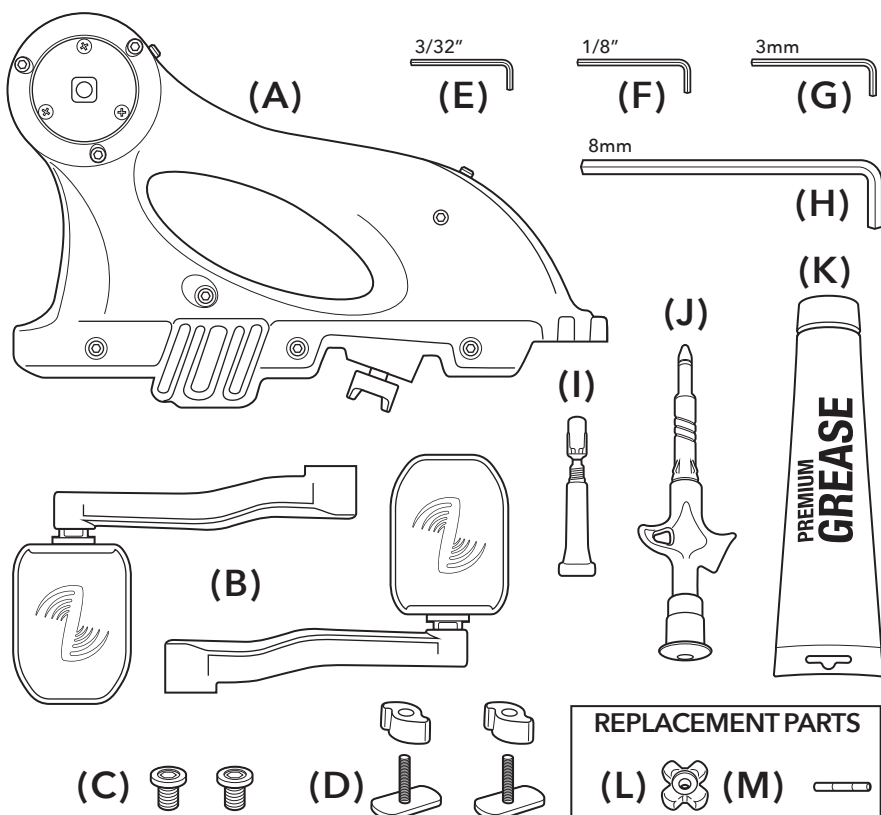

# 1. Attach Crank Arms To The Drive Unit.

- (A) Locate the Crank Arm etched with the letter "L" (for Left) and the Crank Arm etched with the letter "R" (for Right).
  
- (B) With the Upper Drive Unit facing forward as shown, attach the Left Crank Arm on the left side and the Right Crank Arm on the right side using the Crank Arm Bolts. Tap Crank Arms on with palm or hand before tightening bolts.

Add 2-3 drops of single use Loctite to threads of bolts before installing.

Tighten firmly (to 25 ft.-lbs.) using the 8mm Allen Wrench

**IMPORTANT: Periodically check Crank Arm Bolts during break-in period (first 3 uses) to ensure tightness.**

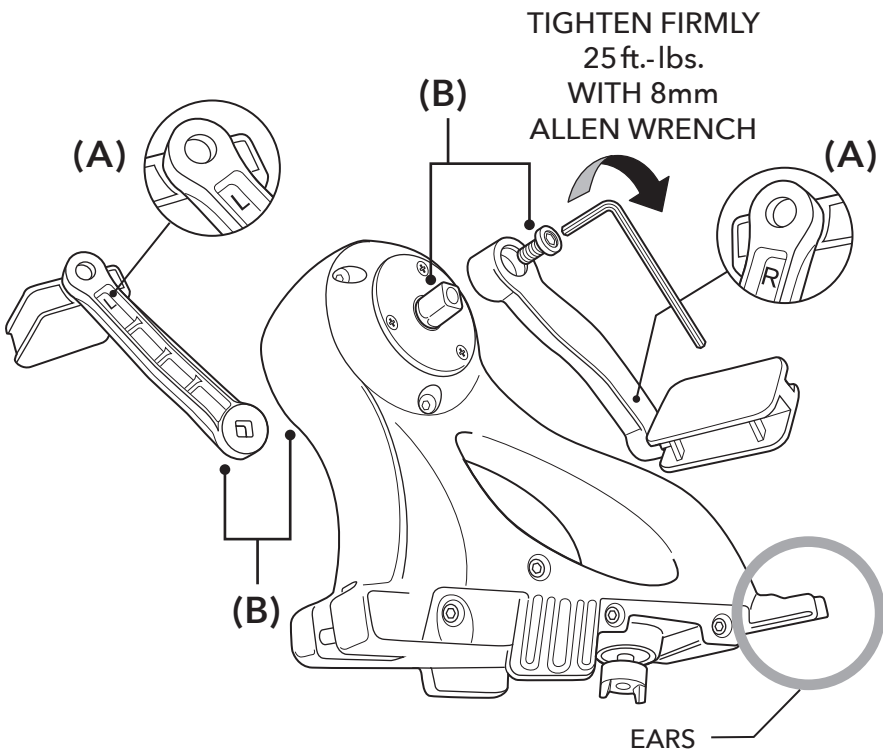

## 2. Connect Upper Drive Unit to Lower Drive Unit.

- (A) Before lowering the Upper Drive Unit onto the Lower Drive Unit, turn the pedal cranks a few turns to note the rotating shaft; this will unite with the coupling in the lower unit to form the drive shaft's universal joint.
- (B) This shaft and coupling must align properly in order for the two drive units to seat correctly.
- (C) As you lower the Upper Drive Unit onto the trunk of the Lower Drive Unit, align the shaft coupling and gently seat the upper drive onto the trunk ensuring the "ears" of the upper drive align with gear track and seats fully with no gap.

**Note the "spider" coupling atop the flexible shaft; it is designed to wear over time. A complimentary replacement is included in your packaging.**

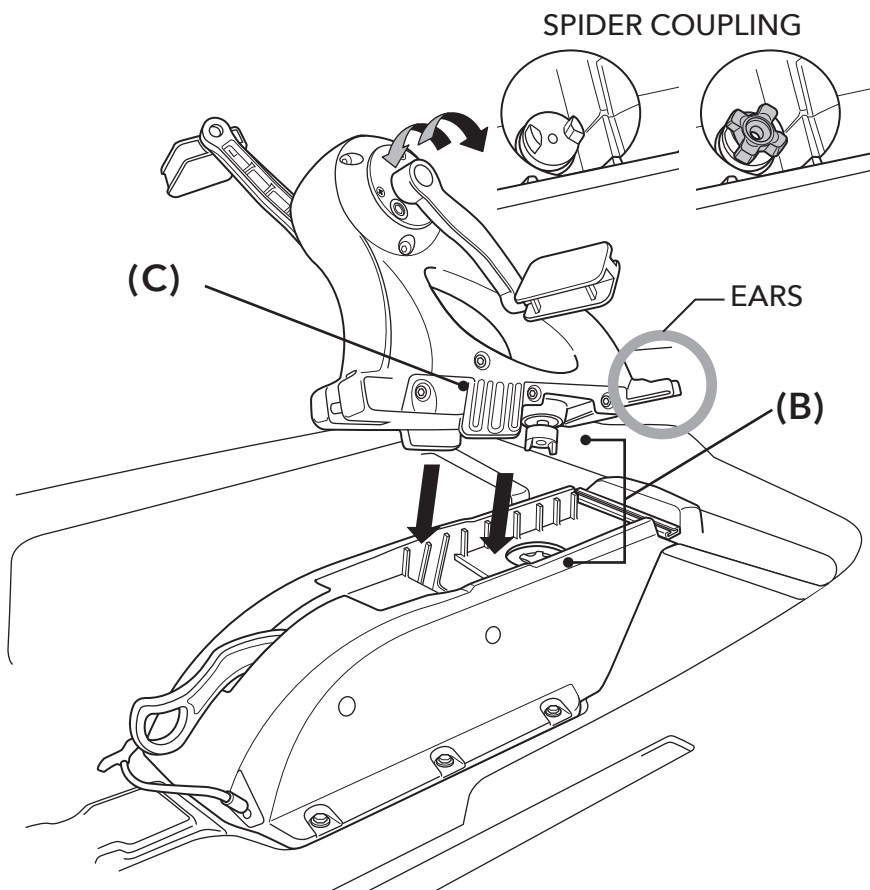

### 3. Secure Upper Drive Unit to Lower Drive Unit.

- (A) When properly seated, the Upper Drive Unit sits flush on the aluminum track. There should be no gap.
- (B) Tighten down the Upper Drive Unit using the attached t-bolt and knobs.

**IMPORTANT:** Upper Drive Unit must be securely tightened at all times while on the water. In the event of capsizing, the Upper Drive Unit can become detached and lost if not securely fastened to the deck.

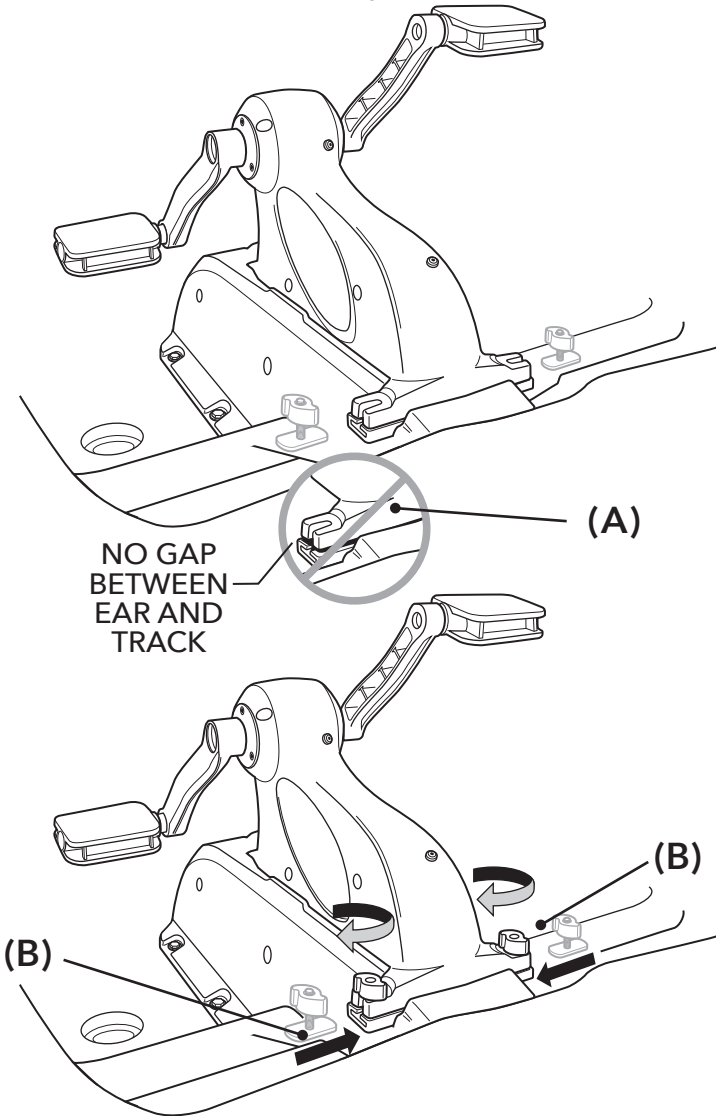

## 4. Raise and Lower the Prop.

Before locking it down, use the lever to raise and lower the prop. Confirm the prop is fully deployed when the lever is in the up position. Turn the pedal cranks forward and backward to confirm FlexDrive-3D is functioning properly. Close and lock down the Cover.

### Fully Retracted

- (A) Fully retract the drive in very shallow water where you will paddle or pole your boat, when landing, when cleaning the prop and during transport.

### Mid-Position

- (B) Mid-position is for operation in shallow water (approximately 8" depending on load), to pass over submerged logs and rocks, and when it is desirable to run at lower speeds (when trolling, for instance).

### Fully Deployed

- (C) Full deployment of FlexDrive-3D is for normal operation in deeper water and for pedaling at full speeds and covering water fast.

**Close the scupper cover to prevent backwash from the prop.**

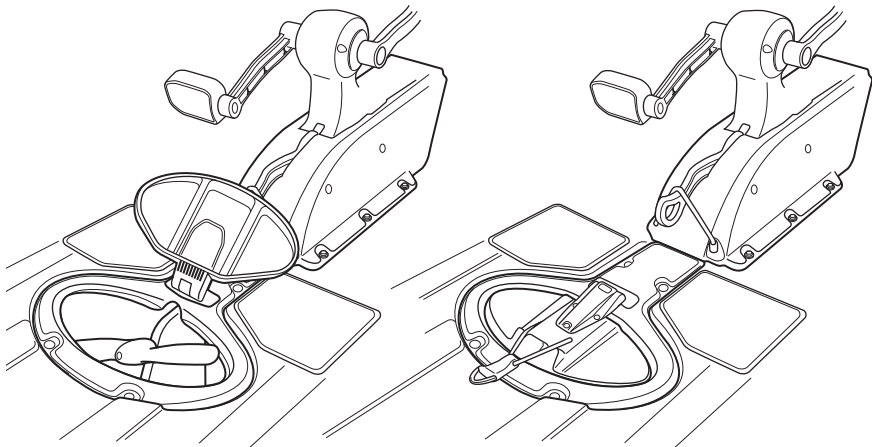

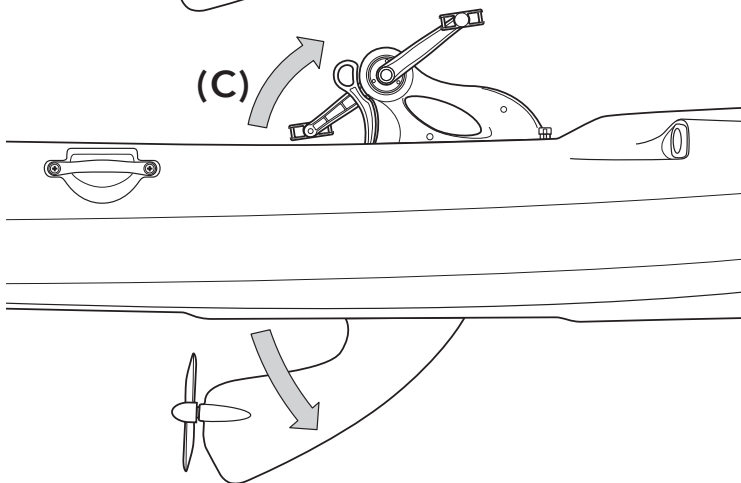
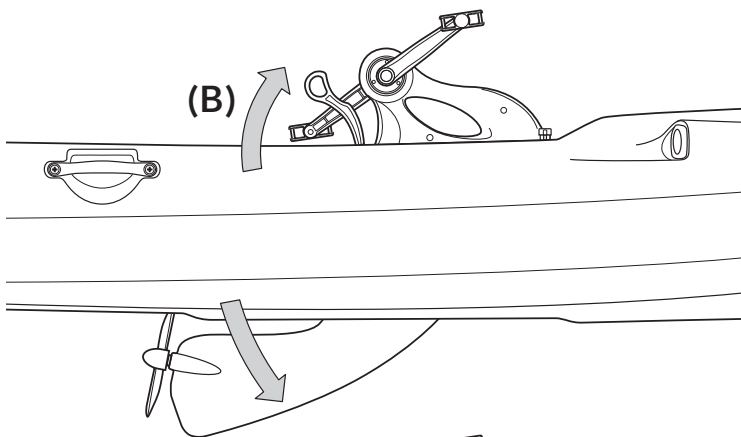
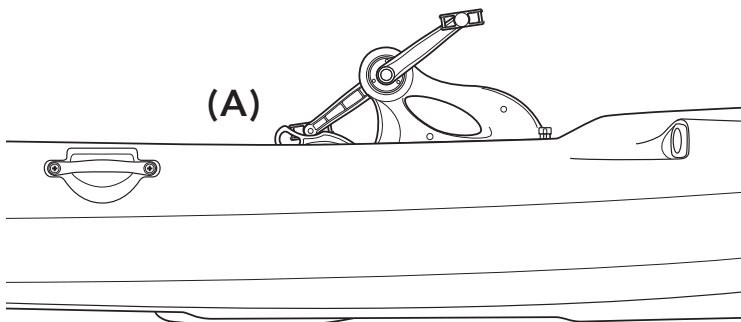

## 5. Rudder Operation.

Jackson FD Rudder controls are located on left and right side gunwale to control the rudder with either hand. If controls feel stiff, lubricate the fiberglass rods with silicone spray (not included).

**(A) From the left rudder control,** to turn your boat left, push the control forward (toward the bow). To turn right, pull the control back (toward the stern).

**From the right rudder control,** to turn your boat right, push the control forward (toward the bow). To turn left, pull the control back (toward the stern).

**(B)** Rudder control knob flips down and lays flat when not in use.

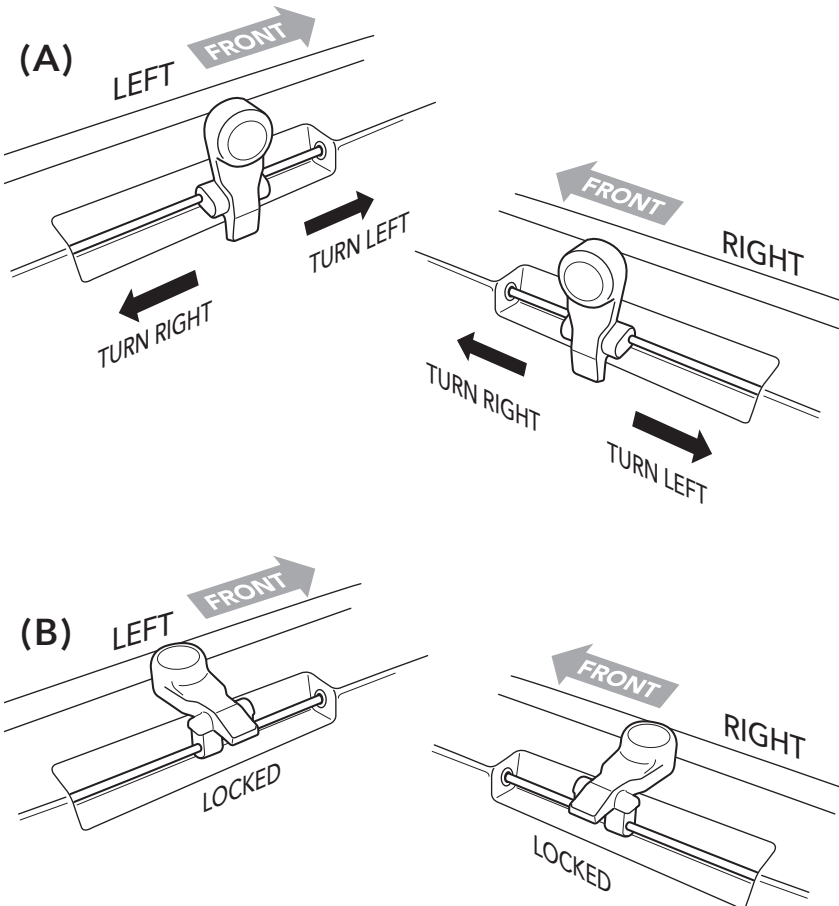



## 6. Transporting FlexDrive-3D.

### IMPORTANT:

Remove the Upper Drive Unit from the boat whenever your boat is in transport. Make sure the lower drive unit is not deployed, so that the propeller is flush with the bottom of the boat.

- (A) Wrap the bungee around the deployment lever to prevent the Lower Drive Unit from deploying and possibly damaging the unit or the car's roof (if the boat is car-topped).

**When Drive Unit is fully retracted and secured, it is safe to transport your boat on racks upside down or right side up.**

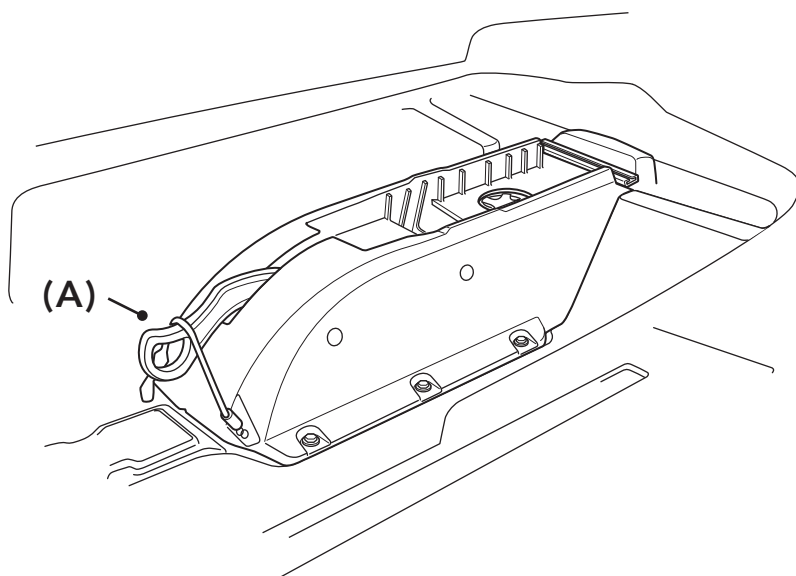

**IMPORTANT! Use bungee to secure handle during transport.**

## 7. Changing Prop Shear Pin

In the event of a severe bump, the prop pin should break to avoid damaging the bottom unit or the propeller. We have supplied a spare prop shear pin that is easily replaced to quickly make your drive system operational again.

**IMPORTANT: Removing the prop should take place on land in the event you drop any of the components.**

- (A) Use the 3mm hex key to loosen the prop screw
- (B) Remove the prop from the shaft
- (C) Remove the black plastic sleeve from the prop shaft. Remove the broken shear pin. Replace the shear pin and the black plastic sleeve. Replace the prop and tighten prop screw snugly

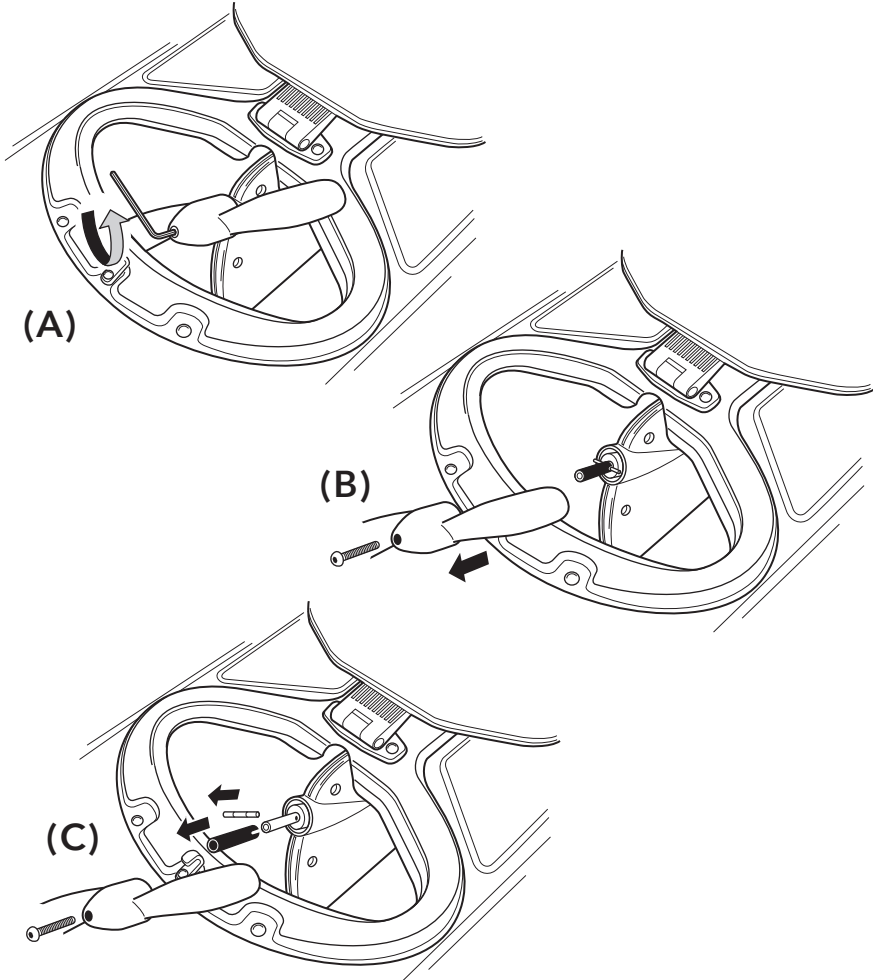

## 8. FlexDrive-3D Maintenance.

FlexDrive-3D is a sealed system only requiring occasional re-greasing, suggested maintenance schedule below. All gearing resides in the Upper Drive Unit away from water contact.

### Spray Off Your Flex Drive

- (A) It is a good idea to spray off your FlexDrive-3D with fresh water after each use (especially when used in salt water) to prevent build-up of dirt or salt.
- (B) Periodically remove the prop and inspect for any grit or sand build-up.

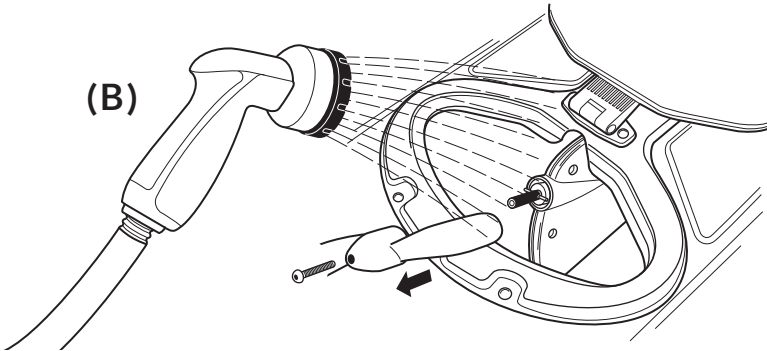
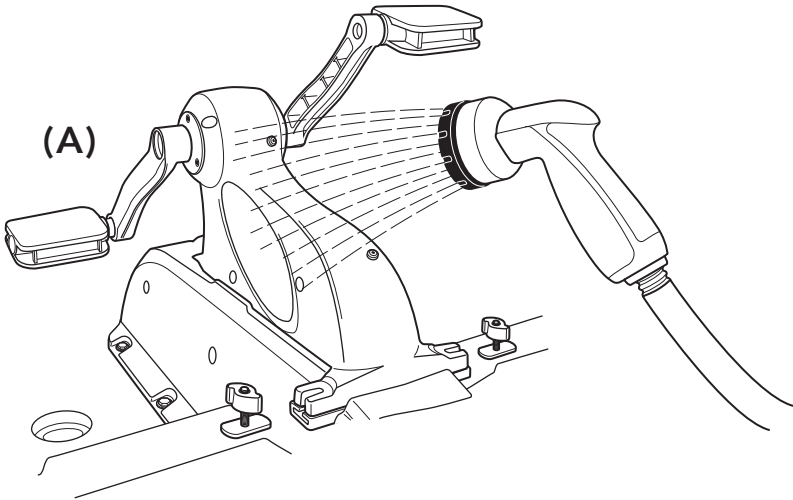

Do not disassemble the upper unit. If you are experiencing problems contact your dealer or Jackson Adventures customer service.

931-738-4800 [warranty@jacksonadventures.com](mailto:warranty@jacksonadventures.com)

## 8. FlexDrive-3D Maintenance. (cont.)

**We suggest you re-grease your upper drive unit:**

- 1) After first use (break in period)
- 2) After first week of use
- 3) After first month of use
- 4) As needed if you start to experience any noise or friction when pedaling

**(A)** To apply grease, remove grease screws with provided 1/8" allen key and set screws aside.

**(B)** Add 10- 12 pumps of grease to both fore / aft grease holes while slowly rotating crank arms to evenly distribute grease.

**Re-install grease screws once grease has been applied.**

We suggest you do re-greasing in a controlled environment and not on the water.

You can also watch a step by step JK FlexDrive-3D maintenance video at [www.jacksonadventures.com/fdmaintenance](http://www.jacksonadventures.com/fdmaintenance) for more information.

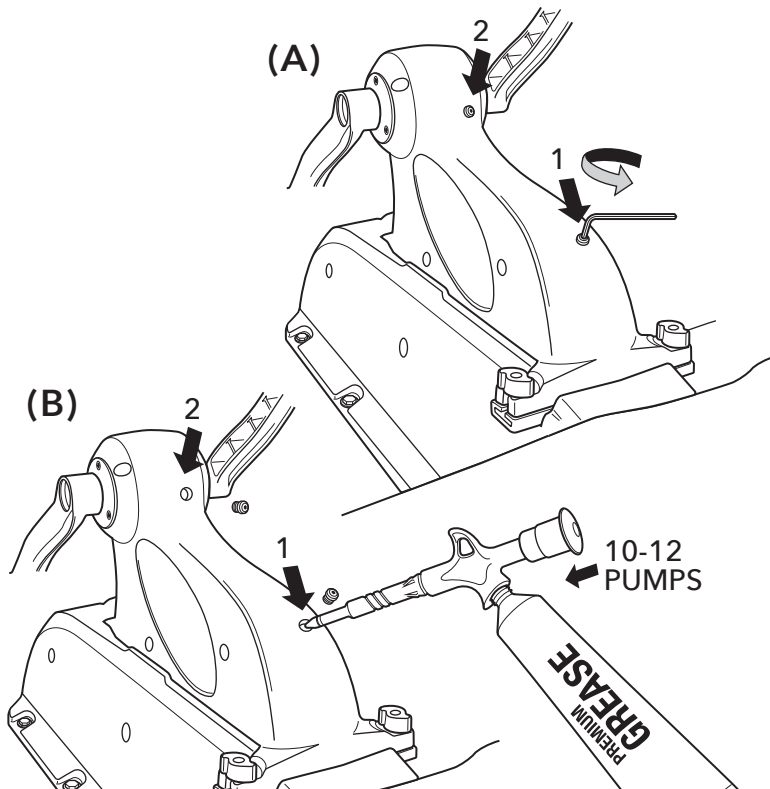

**Notes:**

**Notes:**

**Notes:**



## **TWO YEAR LIMITED WARRANTY**

Jackson Adventures proudly manufactures FlexDrive-3D to the highest standards of quality and dependability and warrants your new FlexDrive-3D against defects in workmanship and materials for two years from purchase date.

Original purchaser must register their boat by way of the Jackson Adventures website within two weeks of purchase. This warranty covers original purchaser only and is not transferable.

For warranty claims, contact the dealer who sold the boat. The dealer must submit your claim to Jackson Adventures and it must include:

Serial number of boat

Serial number of FlexDrive-3D

Proof of purchase

Photographic evidence of damage

Normal wear, damage caused by abuse or neglect, failure to perform maintenance, improper transport or any modifications to the original product invalidate this warranty.

[www.jacksonadventures.com](http://www.jacksonadventures.com)

